



MTU MAINTENANCE ZHUHAI TO ESTABLISH ADDITIONAL FACILITY IN JINWAN DISTRICT

News / Maintenance / Trainings



MTU Maintenance Zhuhai, a joint venture between MTU Aero Engines and China Southern Airline Company limited, announces plans to establish a second facility in the neighboring Jinwan district. The facility is to be called MTU Maintenance Zhuhai Co., Ltd. Jinwan Branch, will have an initial annual capacity of 250 shop visits and expects to enter operations in 2024. The purchase of a 150,000 square meter plot of land has been agreed with local government and the project will now enter the detailed planning and construction stages.

“We have made the decision to invest in an additional facility as we are confident of continued recovery in the Asian region and increasing growth and demand for narrowbody engine services moving forward,” says Michael Schreyögg, Chief Program Officer at MTU Aero Engines. While MTU Maintenance Zhuhai saw an impact on its figures in the second quarter, the facility is now back operating at nearly 100 percent once more.



MTU Maintenance Zhuhai Co., Ltd. Jinwan Branch will focus on Pratt & Whitney narrowbody engines, have its own 65,000 lbf test cell and, according to current estimates, a workforce of around 600 qualified employees. “Its close proximity to MTU Maintenance Zhuhai will enable significant knowledge transfer and synergies between the two facilities,” adds Jaap Beijer, President and CEO of MTU Maintenance Zhuhai, who will be managing the two sites upon completion. The new facility will operate under MTU Maintenance Zhuhai and its licenses and approvals.

Both facilities benefit from their proximity to Hong Kong, Guangzhou, Shenzhen and Macao. Service teams can be dispatched to the customers in the region in no time. The current MTU Maintenance Zhuhai shop has an advanced machinery and performs 80 percent of parts repairs in-house. In addition to China Southern, MTU Maintenance Zhuhai serves over 70 customers from China, Asia and around the world, including International Aero Engines, Saudia Airlines and All Nippon Airways, as well as Chinese Shenzhen Airlines, Xiamen Airlines and Hainan Airlines. The new site will also provide MRO to third party customers.

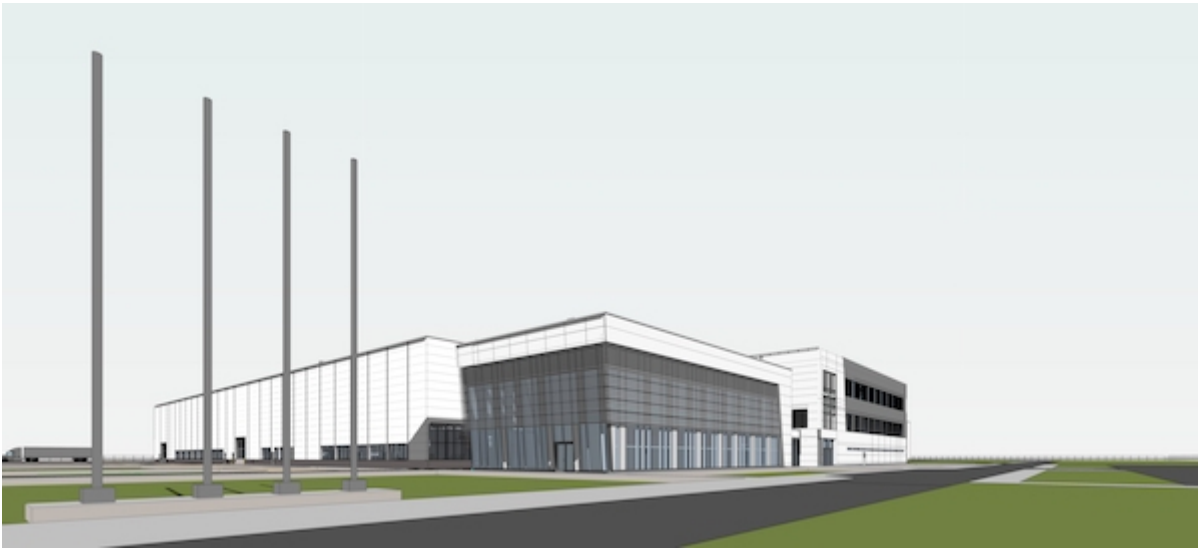

24 NOVEMBER 2020

ARTICLE LINK:

<https://50skyshades.com/index.php/news/maintenance-trainings/mtu-maintenance-zhuhai-to-establish-additional-facility-in-jinwan-district>